

[illegible]

DETALHAMENTOS
ESC: 1/220

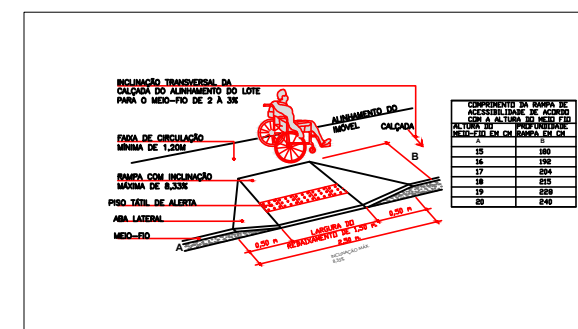

CENTRAL GLP

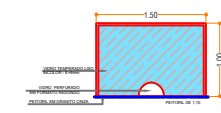
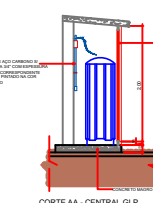
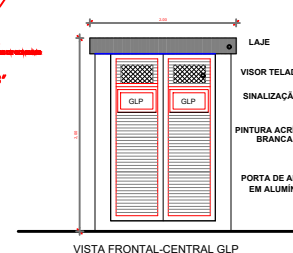
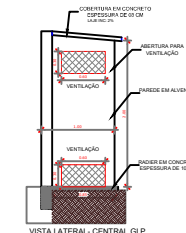
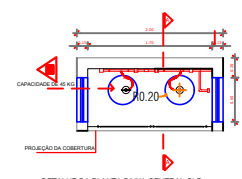

MASTRO

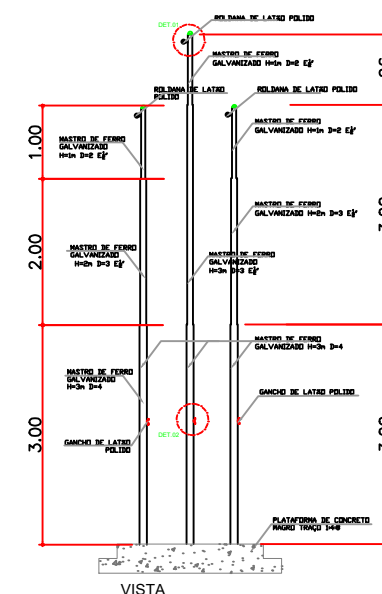
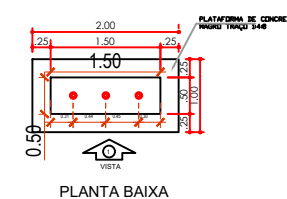
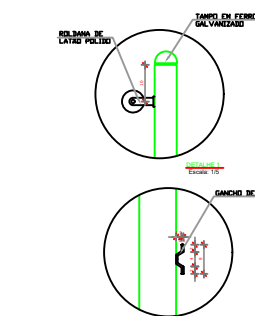

<p align="center">PREFEITURA MUNICIPAL DE VÁRZEA GRANDE Av. Castelo Branco, Espaço Municipal, 2500 - Centro Sul, Várzea Grande/MT CEP 78125-700 - Fone/Fax: 65 3688 8000</p>	
LOCALIZAÇÃO:	<p>RUA SÃO PAULO (LOT. NOVA VÁRZEA GRANDE) CEP: 78135-730 VÁRZEA GRANDE - MT</p>

PROJETO:	PROJETO DE ARQUITETURA
OBRA:	REFORMA E AMPLIAÇÃO DA EMEB JAIME VERÍSSIMO DE CAMPOS JUNIOR "JAIMINHO"

DATA:	JULHO/2021
UNIDADE:	METRO

AUTOR DO PROJETO:

THAIS CORREA DOS SANTOS
ARQUITETA E URBANISTA CAU-MT A-163256-6

ÁREAS:

- ÁREA DO TERRENO: 2.570,30m²
- ÁREA CONS. EXIS: 1.322,23m²
- ÁREA DE DEMOLIÇÃO: 250,00m²
- ÁREA DE AMPLIAÇÃO: 808,33m²
- ÁREA CONSTRUIDA FINAL: 1.880,56m²

FOLHA Nº:
19/19